

IMPORTANT INSTRUCTIONS

For Installation of LS6016



MODELS LS6016

A.C.N. 010 572 773

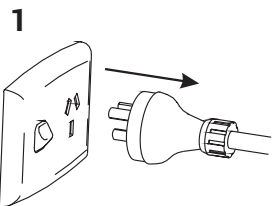

1
Ensure that the fixture is electrically isolated.

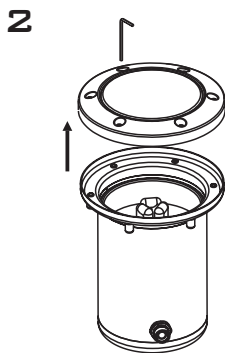

2
Open fixture using allen key or screwdriver.

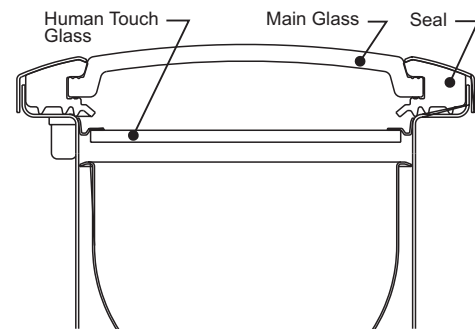
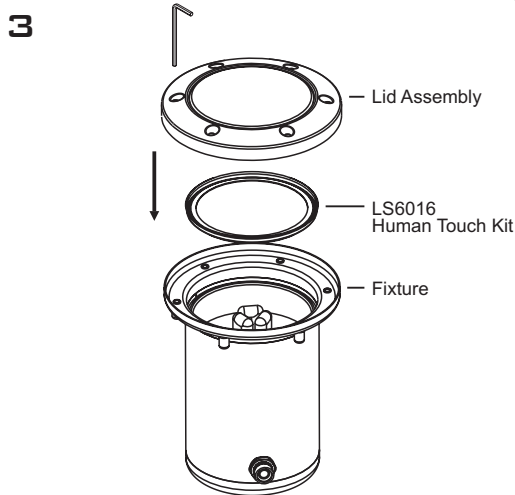

3
Insert Human Touch glass into fixture and reseal.

www.lumascope.com.au

LUMASCAPE LIGHTING INDUSTRIES PTY. LTD. 38-44 Enterprise St, Cleveland, QLD Australia 4163
PHONE - INTERNATIONAL Ph: 61 7 3286 2299 Fax: 61 7 3286 6599
LUMASCAPE USA INC. 1300 Industrial Rd., Unit #19 San Carlos, CA 94070, USA
Free Call: 1-866-695-LUMA(5862) Ph: 1-(650)-595-LUMA(5862) Fax: 1-(650)-595-5820

C1081 - 2006_11_REV-001

IMPORTANT INSTRUCTIONS

For Installation of LS6016



MODELS LS6016

A.C.N. 010 572 773

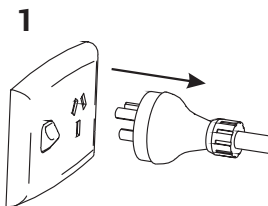

1
Ensure that the fixture is electrically isolated.

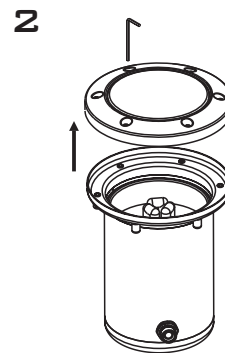

2
Open fixture using allen key or screwdriver.

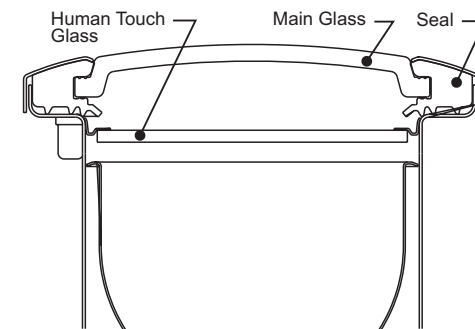
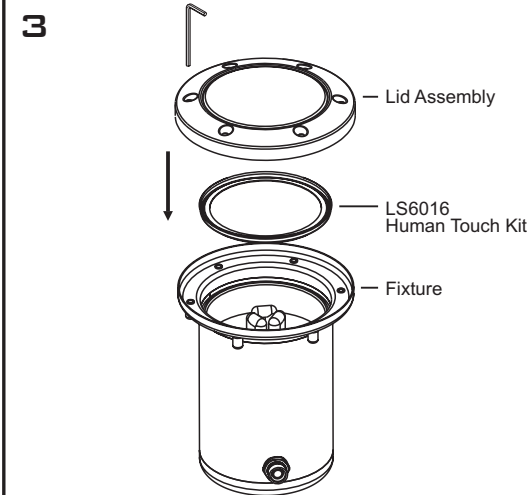

3
Insert Human Touch glass into fixture and reseal.

www.lumascope.com.au

LUMASCAPE LIGHTING INDUSTRIES PTY. LTD. 38-44 Enterprise St, Cleveland, QLD Australia 4163
PHONE - INTERNATIONAL Ph: 61 7 3286 2299 Fax: 61 7 3286 6599
LUMASCAPE USA INC. 1300 Industrial Rd., Unit #19 San Carlos, CA 94070, USA
Free Call: 1-866-695-LUMA(5862) Ph: 1-(650)-595-LUMA(5862) Fax: 1-(650)-595-5820

C1081 - 2006_11_REV-001