

LS353LED Shallow Inground

FOR OUTDOOR USE

WARNING

It is strongly recommended to use LEDscape power supply or transformer

All connections must be kept dry; failure to do so may result in product reliability issues

Opening luminaire will void warranty

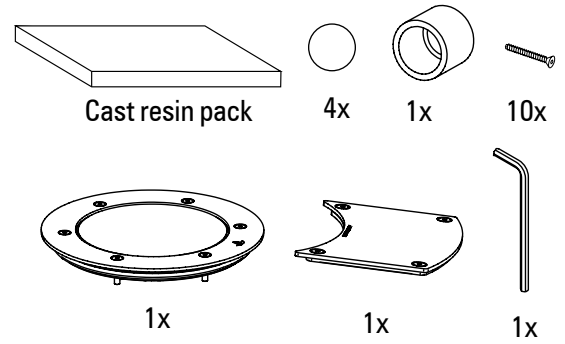
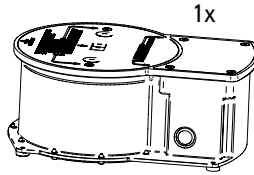
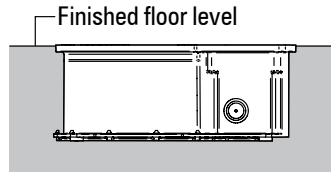

1.

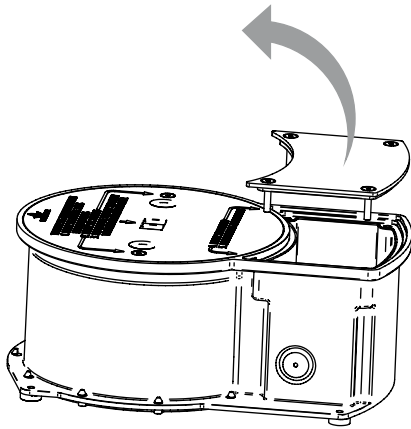

2.

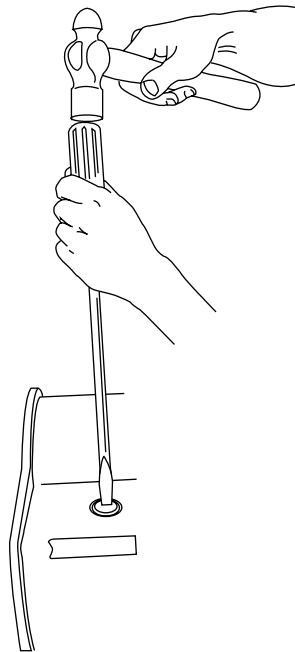

3.

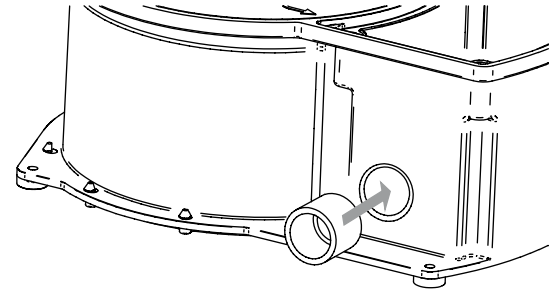

4.

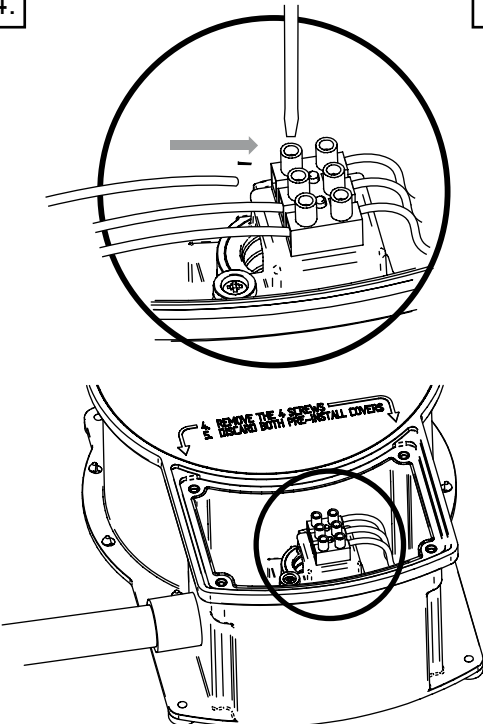

5.

Ensure conduit hole is completely blocked using green putty (supplied)

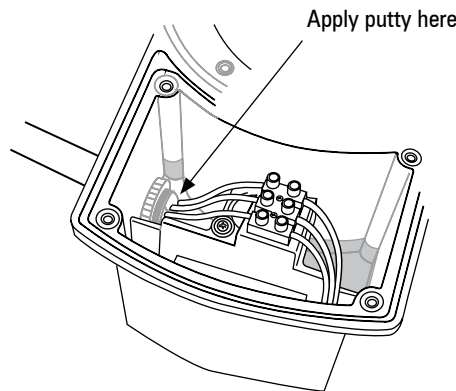

6.

Pour cast resin into cable entry chamber. DO NOT OVERFILL

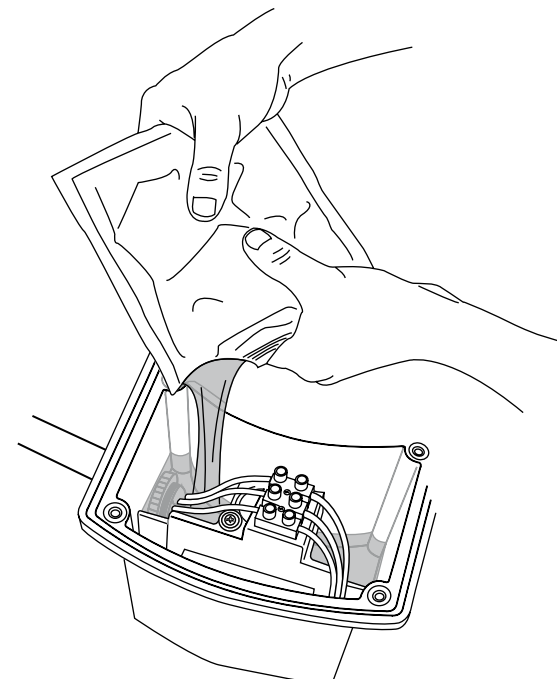

7.

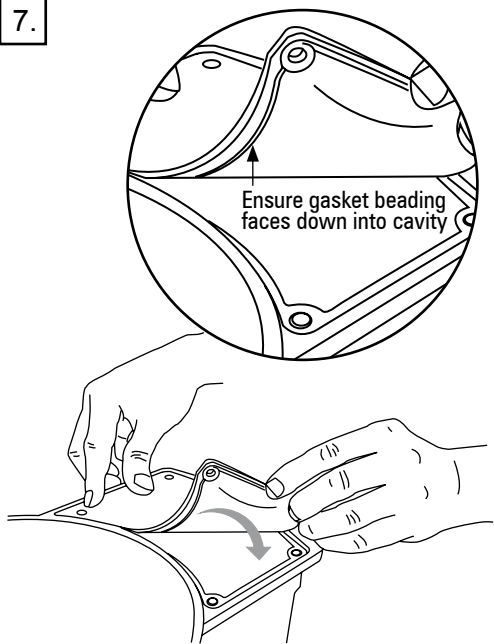

8.

Re-assemble aluminium lid. Tighten screws.

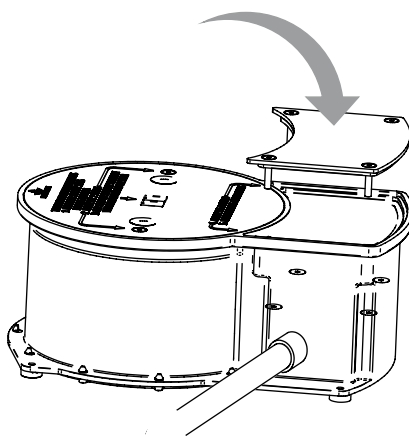

9.

Cover the screw heads with supplied stickers.

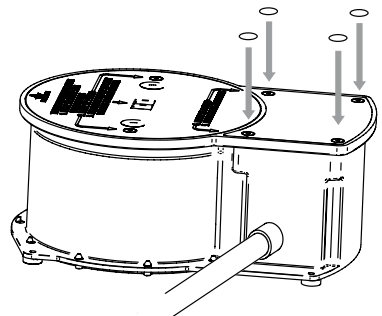

10.

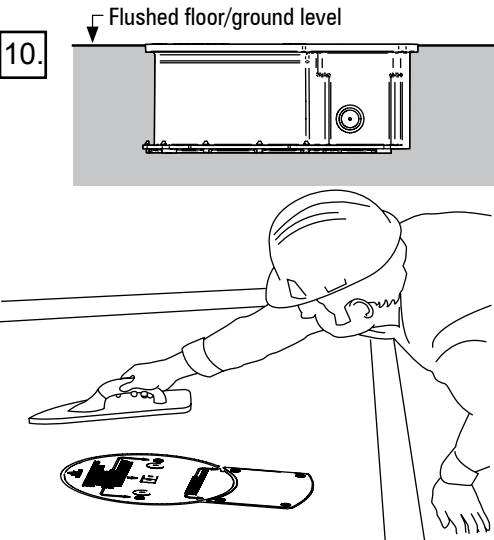

11.

Discard plastic lid and black o-ring. Discard aluminium lid. **RETAIN GASKET.**

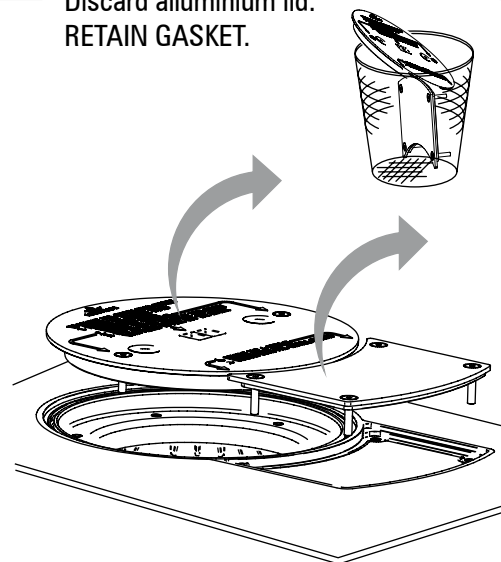

12.

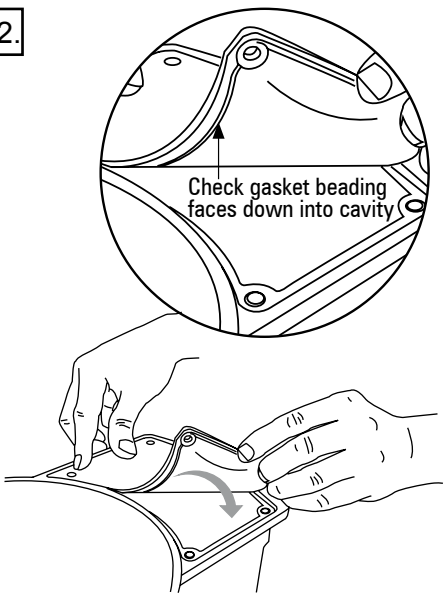

13.

Fit stainless steel lid. Tighten screws.

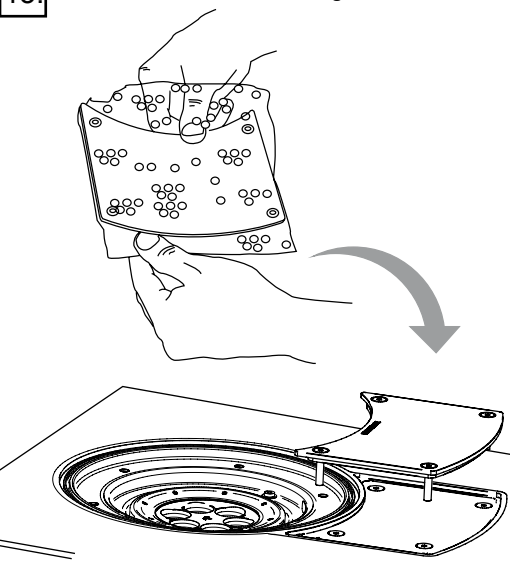

14.

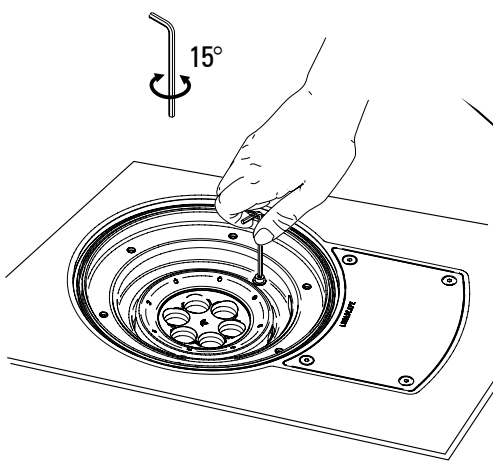

15.

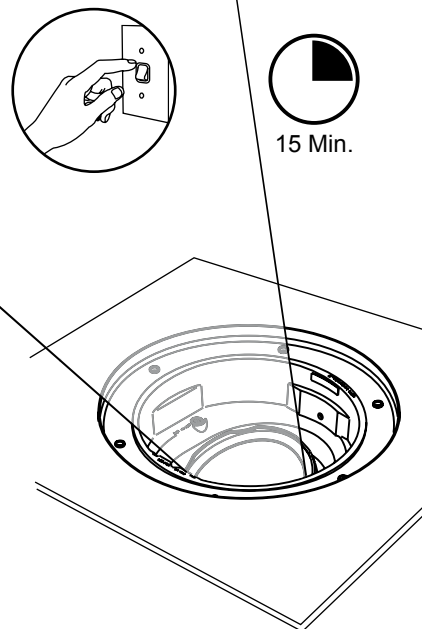

16.

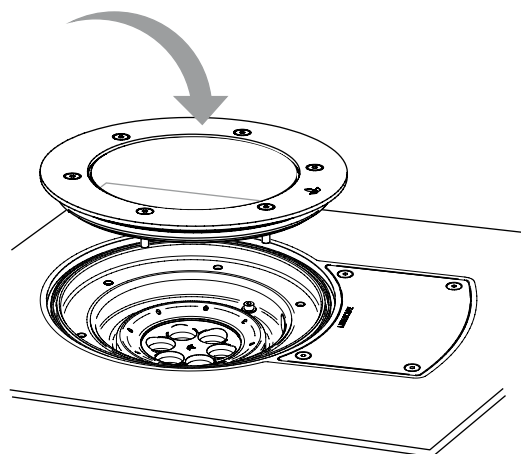

17.

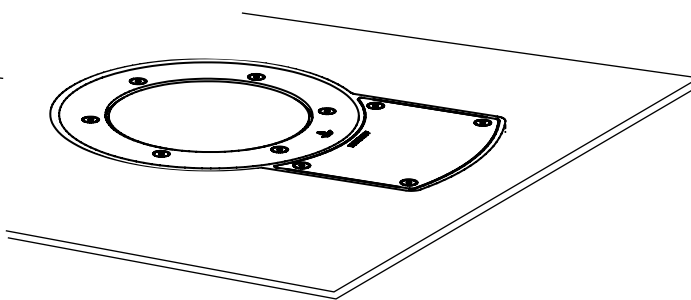

SAFETY INSTRUCTIONS

WARNING - To reduce the risk of FIRE or INJURY:

1. Luminaires and transformers to be installed by quality installers only.
2. Luminaires to be used for intended purpose only. e.g. Wall Mount fittings must be wall mounted.
3. Luminaires can become very hot. Use discretion in placement.
4. Do not touch hot lens, guard, or enclosure.
5. CAUTION - HOT SURFACE. Keep away from curtains and other combustible material.
6. Turn Off/Unplug and allow to cool before replacing lamp.
7. Keep lamp away from materials that may burn.
8. Never touch lamp with bare fingers. Oil from skin may damage lamp. Hold lamp with soft cloth when installing or replacing.
9. Do not operate the luminaires with a missing or damaged parts.
10. Replace any cracked protective shield.
11. Use only lamp type, voltage and wattage as specified by Lumascope on the product label.
12. Use only genuine Lumascope parts to replace damaged or missing components.
13. Refer to instructions for installation and operating requirements.
14. Ensure installation complies with local regulations

SAVE THESE INSTRUCTIONS.