



The LS393LED is a compact inground option, utilising 6 W LED. **HumanTouch™** is an important feature of this series, allowing placement in accessible areas. Adjustability of the optics ensures light can be delivered where it is required.

SPECIFICATIONS

LED Source	LED 6 W ⁽¹⁾ <input type="checkbox"/> White (4300 K typical) <input type="checkbox"/> Warm white (3000 K typical) <input type="checkbox"/> Blue (470 nm) <input type="checkbox"/> RGB
Dimmable	Using LS6125 0-10 V dimming <i>NOTE: 4 wires circuit required to be run to luminaire.</i>
IP Rating	IP68
Construction	316 marine grade stainless steel
Installation Types	Direct burial <i>Landscapes, etc.</i> Mounting collar <i>Decks and grates</i> (LS647) Pre-installation blackout <i>Drive-over or other applications requiring pre-installation</i> (LS637-K - single colour line voltage) (LS647-K - single colour low voltage)
Drive-over	With OptiClear™ lens and pre-installation blackout (LS647-K / LS637-K)
Static Load Rating	3750 kg with OptiClear™ lens and pre-installation blackout (LS647-K / LS637-K)
Impact Rating	IK9 with OptiClear™ lens
Standard Inclusions	Integral driver for line voltage, or Integral driver for low voltage with field intensity setting Teflon coated cover screws MicroAntiLeach™ cable entry Thermal cutout
Ambient Operating Temperature	-20 °C to +50 °C
Warranty	10 year structural, 1 year electrical
Accessories <i>Order separately</i>	Refer to page 3 for direct burial LED Refer to page 5 for pre-installation LED
Photometrics	Go to www.lumascape.com.au ▶ Technical Data ▶ Photometric Files
Glass Temperature	HumanTouch™ compliant ≤65 °C

NOTE: Product specifications are subject to change without notice. Any luminaire can become hot - take care with appropriate use and placement

⁽¹⁾ Nominal power consumption only, actual power consumed may vary.



LS393LED Recessed Cover



LS393LED Round Flush Cover



LS393LED Pre-installation Round Flush Cover

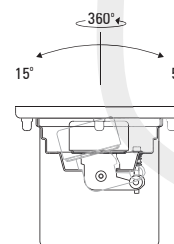

WHY USE DIRECT BURIAL

Direct burial installation is ideal for landscaping areas or in locations where the depth is restricted. This type of installation also allows for maximum heat dissipation. The stainless steel construction of the luminaire performs flawlessly in alkaline and acidic soil types, as well as chemically fertilised landscapes.

Cable Entry Option for Direct Burial

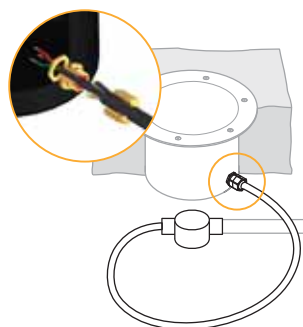

Armoured Cable MC & Junction Box

Armoured cable 0.6 m provides protection against damage to cable between luminaire and 3 way junction box (included). Allows for loop in/loop out and flexibility of luminaire placement.

Not available for RGB option

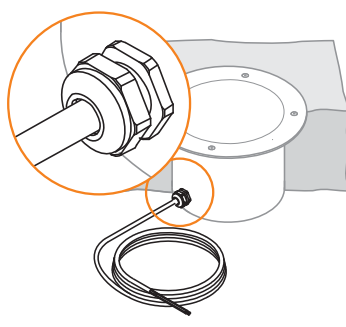

Single Gland Entry

MicroAntiLeach™ and 3 m flexible cable provide additional protection to luminaire against water ingress via cable.

Lens Options

OptiClear™ Glass
Glass of very high optical purity and load strength. Suitable for drive-over applications.

GripGlass™
OptiClear™ glass with slip reduction glazing process. Suitable for drive-over applications.

Borosilicate Glass
Ideal for general use areas. Not suitable for drive-over application.

Cover Options for Direct Burial



Recessed Cover

- SS316: Polished
- SS316: Brushed

Use recessed cover for installation in soil, grass, pavers and other uneven surfaces where no cover overhang is desired.

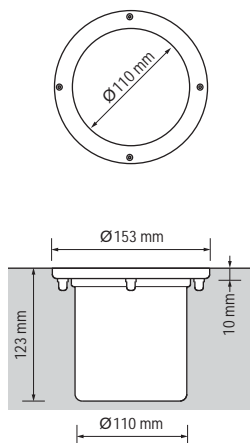

Round Flush Cover

- SS316: Polished
- SS316: Brushed

Use flush covers for installation in fine finished surfaces such as granite and marble. They can also be used in some suspended applications (decks, etc). The flush cover will conceal gaps between the luminaire and the surrounding surface.

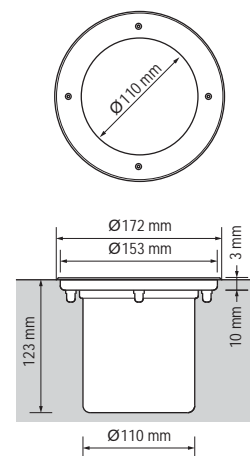

 CONFIGURE THIS PRODUCT >

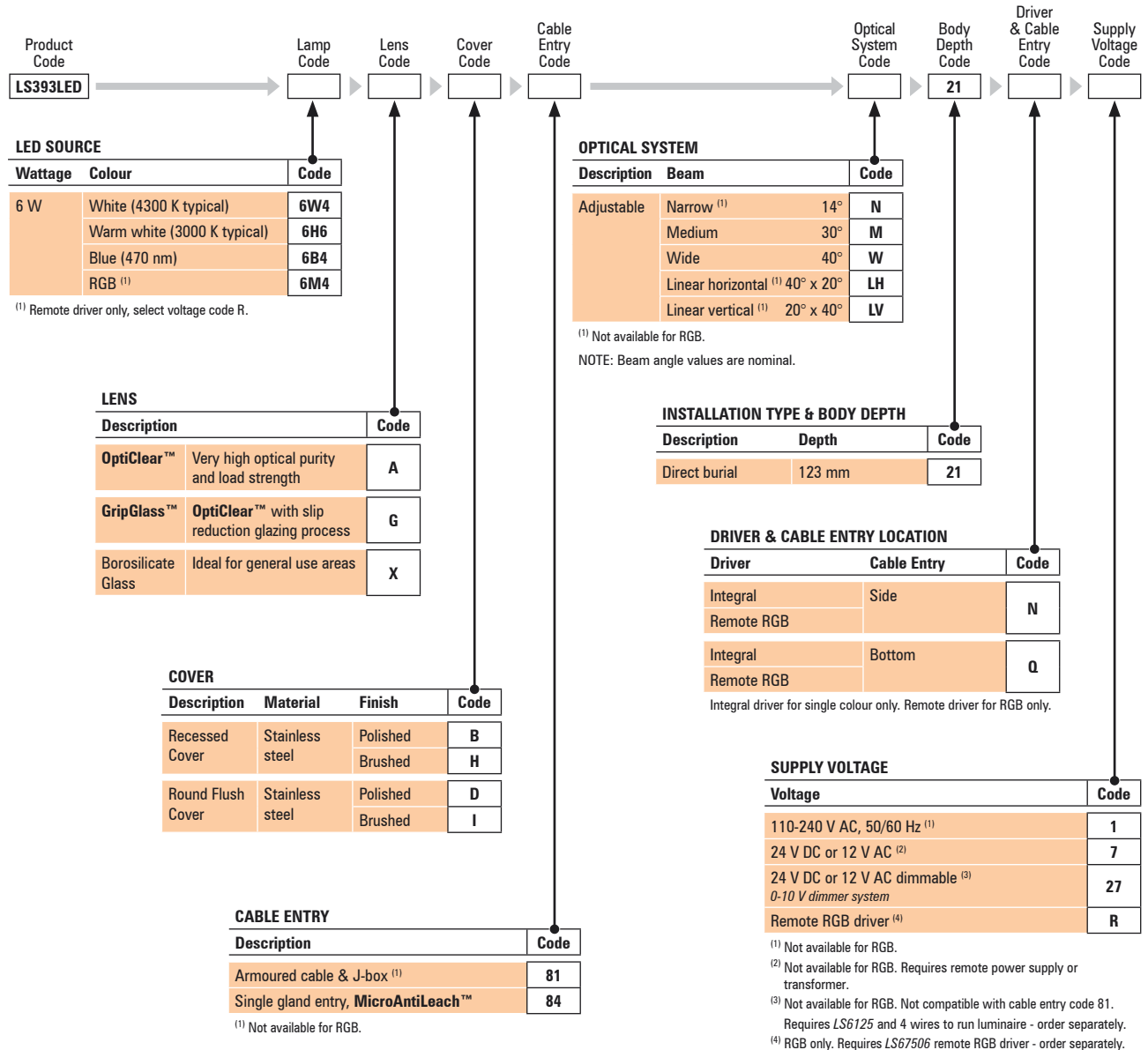

ACCESSORIES

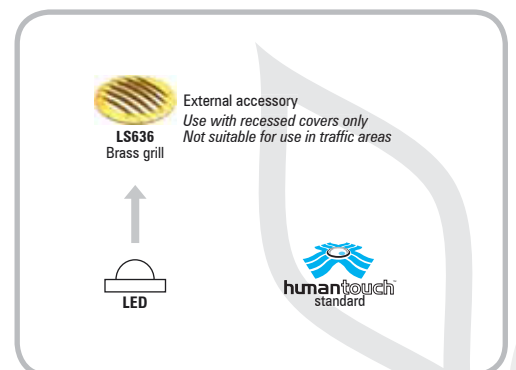

Other accessory stacking options may be available - consult factory

WHY USE PRE-INSTALLATION BLOCKOUT

This type of installation requires the LS647-K (for low voltage supply) or LS637-K (for line voltage supply) pre-installation kit (order separately) which acts as a blockout, and is intended for installation before the luminaire. This method ensures the luminaire itself is not damaged during concreting or other site works, and also allows for all wiring to be completed prior to luminaire placement. Pre-installation also allows

for off-site maintenance, via the detachable IP68 connector fitted on the luminaire housing.

The mating connector on the cable has a sealing cap which ensures water does not enter the cable before the installation is completed. Pre-installation is required for all drive-over applications.

WHY USE MOUNTING COLLARS

The LS647 mounting collar supports installation in decks and grates. They may also be used in hollow floors where there is appropriate ventilation.

Cable Entry Option for Pre-Installation Blockout



IP68 Connector & Junction Box

The luminaire is fitted with an IP68 connector, which attaches directly to the cable supplied with LS647-K or LS637-K, without the use of any tools. The cable is 0.56 m in length, and is factory assembled with a 3 way junction box.

LS647 mounting collars must use a single gland entry. See page 2.

Lens Options

OptiClear™ Glass

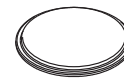

Glass of very high optical purity and load strength. Suitable for drive-over applications.

GripGlass™

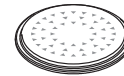

OptiClear™ glass with slip reduction glazing process. Suitable for drive-over applications.

Borosilicate Glass



Ideal for general use areas. Not suitable for drive-over application.

Cover Options for Pre-Installation Blockout

Round Flush Cover

- SS316: Polished
- SS316: Brushed



Flush covers for pre-installation use special seals and support bushes to ensure static loads up to 4200 kg are properly supported. In order to achieve this drive-over rating, OptiClear™ or GripGlass™ must be used.

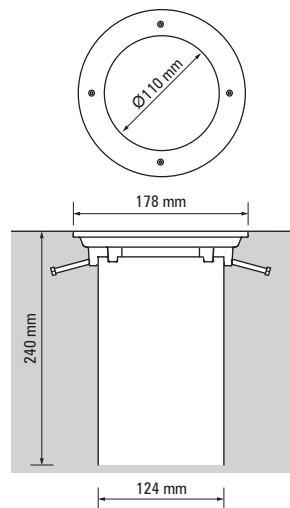

LS647-K pre-installation blockout

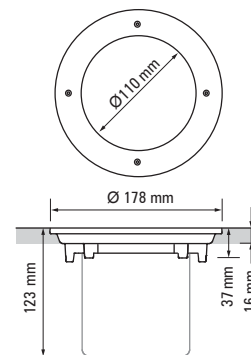

LS647 mounting collar

 CONFIGURE THIS PRODUCT >

Product Code: **LS393LED**

Lamp Code: **6W4**

Lens Code: **A**

Cover Code: **M**

Cable Entry Code: **84**

Optical System Code: **N**

Body Depth Code: **23**

Driver & Cable Entry Code: **Q**

Supply Voltage Code: **1**

LED SOURCE

Wattage	Colour	Code
6 W	White (4300 K typical)	6W4
	Warm white (3000 K typical)	6H6
	Blue (470 nm)	6B4
	RGB ⁽¹⁾	6M4

⁽¹⁾ Remote driver only, select voltage code R.

LENS

Description	Code
OptiClear™ Very high optical purity and load strength	A
GripGlass™ OptiClear™ with slip reduction glazing process	G
Borosilicate Glass ⁽¹⁾ Ideal for general use areas	X

⁽¹⁾ Not suitable for drive-over.

COVER

Description	Material	Finish	Code
Round Flush Cover	Stainless steel	Polished	M
		Brushed	N

CABLE ENTRY

Description	Code
Single gland entry, MicroAntiLeach™ ⁽¹⁾	84
IP68 connector & J-box ⁽²⁾	85

⁽¹⁾ Mounting collar only.
⁽²⁾ Pre-installation blackout only. Not available for RGB and dimming.

OPTICAL SYSTEM

Description	Beam	Code
Adjustable	Narrow ⁽¹⁾ 14°	N
	Medium 30°	M
	Wide 40°	W
	Linear horizontal ⁽¹⁾ 40° x 20°	LH
	Linear vertical ⁽¹⁾ 20° x 40°	LV

⁽¹⁾ Not available for RGB.
NOTE: Beam angle values are nominal.

INSTALLATION TYPE & BODY DEPTH

Description	Depth	Code
Mounting collar ⁽¹⁾	123 mm	23
Pre-installation ⁽²⁾	240 mm	

⁽¹⁾ Requires LS647 - order separately.
⁽²⁾ Requires LS637-K for line voltage (code 1) or LS647-K for low voltage (code 7) - order separately.
For other body depths consult factory

DRIVER & CABLE ENTRY LOCATION

Description	Cable Entry	Code
Integral	Bottom	Q
Remote RGB		

Integral driver for single colour only. Remote driver for RGB only.

SUPPLY VOLTAGE

Voltage	Code
110-240 V AC, 50/60 Hz ⁽¹⁾	1
24 V DC or 12 V AC ⁽²⁾	7
24 V DC or 12 V AC dimmable ⁽³⁾ 0-10 V dimmer system	27
Remote RGB driver ⁽⁴⁾	R

⁽¹⁾ Not available for RGB.
⁽²⁾ Not available for RGB. Requires remote power supply or transformer.
⁽³⁾ Not available for RGB. Not compatible with pre-installation or cable code entry 85. Requires LS6125 and 4 wires to run luminaire - order separately.
⁽⁴⁾ RGB only. Requires LS67506 remote RGB driver - order separately. Not compatible with pre-installation.

ACCESSORIES

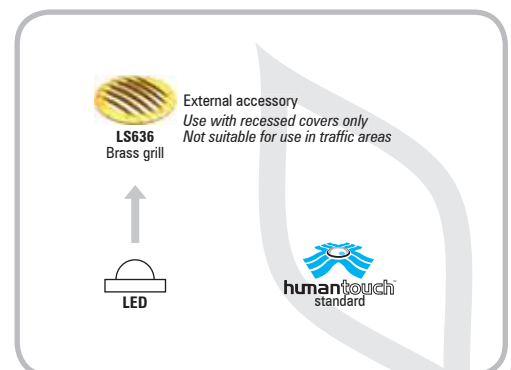

Other accessory stacking options may be available - consult factory