



The Erden E8 Foundation is a high-powered, in-ground uplighter that combines technology and performance in a modern form factor. Packed with features including EasyGlow™ and CoolDrive™ thermal management technologies. Available with DALI, 0-10 V dimming or non-dimmable configurations.

Performance

Static White & Color ¹	Lumen Output (lm)	Efficacy (lm/W)	Peak Intensity (cd)
● 2,700 K (80 CRI)	3,090	95	123,600
● 3,000 K (80 CRI)	3,230	99	128,800
○ 3,500 K (80 CRI)	3,360	103	134,100
● 4,000 K (80 CRI)	3,490	107	139,300
● 5,000 K (70 CRI)	3,490	107	139,300

¹ Lumen output values are based on a 6° lens.

Beam Angles	6°, 15°, 30°, 45°, 60°, 10° x 40°, 40° x 10°, 10° x 60°, 60° x 10°, 20° x 40°, 40° x 20°, 20° x 60°, 60° x 20°
--------------------	----------------------------------------------------------------------------------------------------------------



Products and specifications are subject to change without notice.
LS3082-LS3082_260312

Electrical

Power Consumption	34 W
Lifetime	>179,506 hrs (B10, L90, TM21 Projected)
Input Voltage	International 220 to 240 Vac, 50/60 Hz North America 120/277 Vac, 60 Hz
Thermal Management	CoolDrive™ onboard thermal monitoring and control

Control

Protocols	DALI® 2 (International), 0 to 10 V (North America), Non-Dimmable
------------------	------------------------------------------------------------------

Physical

Housing	Marine-grade 316 stainless steel housing, cover (polished or brushed finish), high-strength glass and teflon-coated cover screws.
Finish	Superior 9-step powder-coating process, including marine-grade epoxy undercoat and polyester top-coat
Installation	Pre-Installation blackout for concrete pour, drive-over and general use applications. Mounting collar for decks and grates. Direct burial for landscapes, planters and special applications.
Mounting Accessories	LS640-K Pre-installation concrete blackout LS640-2 Mounting collar for decks and grates
Adjustable	-5° to +20° tilt, 360° rotation
Ambient Operating Temperature	-40°F to 122°F (-40°C to 50°C)
Surface Temperature	≤149 °F (65 °C)
Weight	15.0 lbs (6.8 kg)
Drive-Over	With OptiClear lens and pre-installation kit (LS640-K)

Certification & Compliance

IP Rating	IP68
IK Rating	IK10
Static Load Rating	9,259 lbs (4,200 kg)
Environment	Dry, Damp, Wet locations Inherently protected Suitable for use in poured concrete
Certifications	cULus, CE, UKCA, RCM

Accessories

Shielding & Glare Control

A range of shielding and glare control accessories are available to suit the Erden E8 In-ground.

LS6235 Diffusion Media

Modifies the harsh quality of light being dispersed by the luminaire by spreading the beam. Order separately.



OR

LS6234 Cross Hatch Louver

Provides additional glare control. Available in black only. Order separately.



Specification Matrix

LS6235	-	
--------	---	--

Degree	Code
10°	10
20°	20
30°	30
40°	40

Technical Drawings

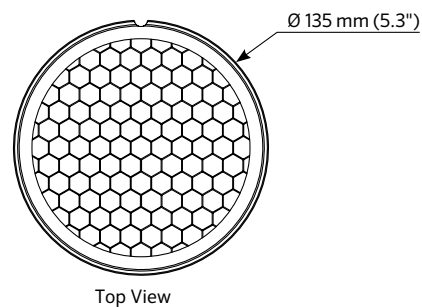

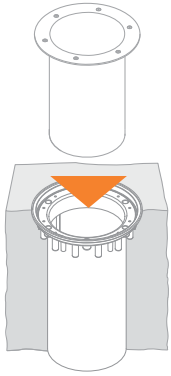

Pre-Installation

This type of installation requires the **LS640-K Pre-Installation Kit** (ordered separately), which acts as a concrete blockout and is intended for installation before the luminaire. This method ensures the luminaire itself is not damaged during concreting or other site works.

Used for	Drive over applications General use applications Concrete pour applications where luminaire is to be installed after site work has been completed.
Benefits	Easy removal for servicing
Restrictions	Connection Type 82 only available for North American market
Accessories	LS640-K Pre-Installation Blockout

Connection type '84'

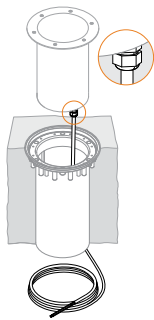

Flexible Cable

For connections to the branch circuit via junction box (by others) or other approved method. 6.5' (2 m) length. For other length options, contact Lumascape.

Connection type '82'
North American market only

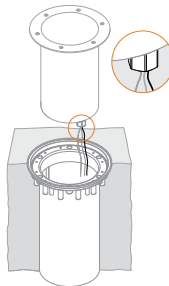

1/2" NPT Adapter

The luminaire is factory-fitted with 6.5' (2.0 m) hookup wire. Ensure terminations can be made within this length. For other length options, consult Lumascape.

Connection type '77/87'

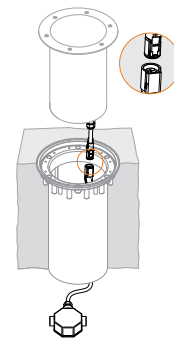

IP68 Connector & Junction Box

The luminaire is fitted with an IP68 connector, which attaches directly to the cable supplied with LS640-K without the use of any tools. The cable is 3' (1 m) in length and is supplied with a junction box.

Flush Cover Options

Flush covers for pre-installation use special seals and support bushes to ensure static loads up to 9,259 lbs (4, 200 kg) are properly supported. In order to achieve this drive-over rating, OptiClear™ or GripGlass™ must be used.



Pre-Installation Blockout Round Flush Cover

- SS316: Polished
- SS316: Brushed

Specification

Use the table below to specify your Pre-Installation Blockout.

LS640-K	-				
Connection Type	Code	Input Voltage	Code	Control	Code
Flexible cable, single entry, for hardwired installations (International) or Hookup wire and 1/2" NPT (82), single entry, for hard wired installations (North America only)	84	220 to 240 Vac, 50/60 Hz (International) 120/277 Vac, 60 Hz (North America)	01 09	DALI (International) 0-10 V (North America)	DL AH
Flexible cable, single entry, for connectorized installations (non-dimming applications only)	87				
Flexible cable, single entry, for connectorized installations	77				

Control code only required for type 77 connection

Technical Drawings - Pre-Installation Kit

Connection type '77'

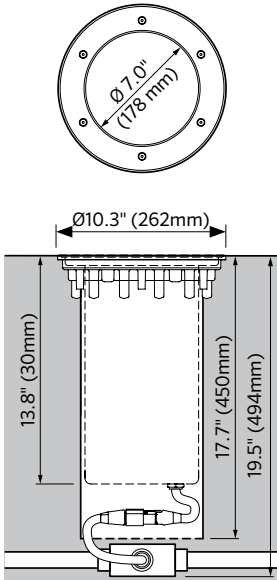

Connection type '87'

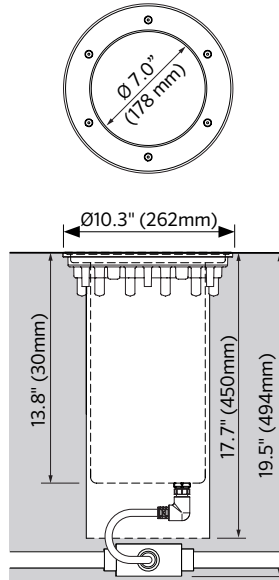

Connection type '82'
North American Market only

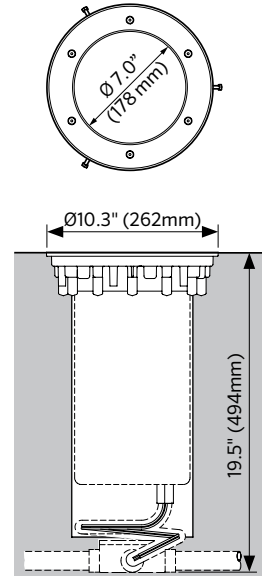

Connection type '84'

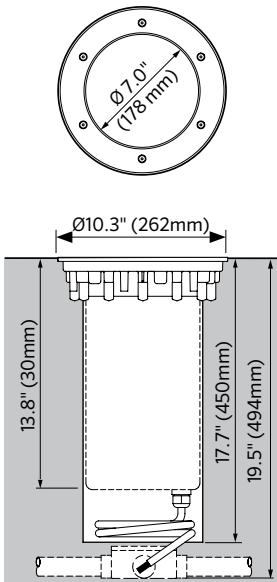

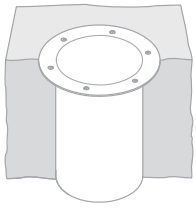

Direct Burial

Luminaire is put directly into soil or concrete.

Used for	Landscaping areas Applications where depth is restricted Rate for use in concrete pour applications Economical options
Benefits	Easy removal for servicing
Restrictions	Not as easy to remove for service as pre-installation version Not suitable for drive-over (requires pre-installation kit) Not available with Connection Types '77' or '87' (requires pre-installation kit) Connection Type '82' only available for North American market

Connection type '84'

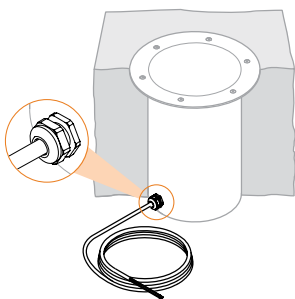

Flexible Cable

For connections to the branch circuit via junction box (by others) or other approved method. 6.5' (2.0 m) length. For other length options, contact Lumascape.

Connection type '82'
North American Market only

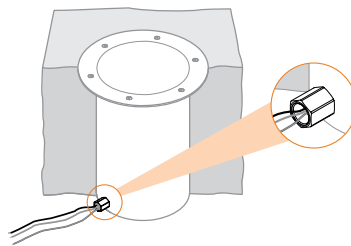

1/2" NPT Adapter

The luminaire is factory-fitted with 6.5' (2.0 m) hookup wire. Ensure terminations can be made within this length. For other length options, contact Lumascape.

Recessed Cover Options

Use recessed cover for installation in soil, grass, pavers and other uneven surfaces where no cover overhang is desired.



- SS316: Polished
- SS316: Brushed

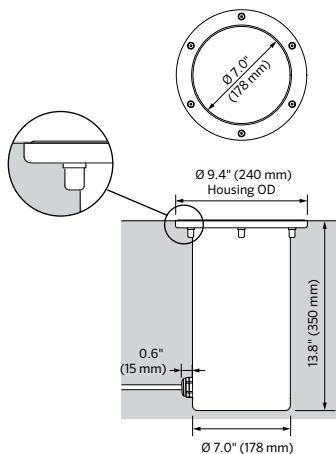

Flush Cover Options

Use flush covers for installation in fine finished surfaces such as granite and marble. They can also be used in some suspended applications. The flush cover will conceal gaps between the luminaire and the surrounding surface.



- SS316: Polished
- SS316: Brushed

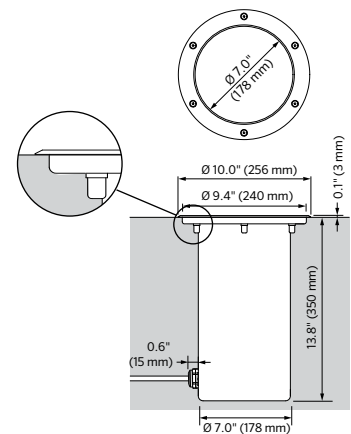

Direct Burial Specification Matrix

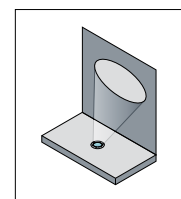
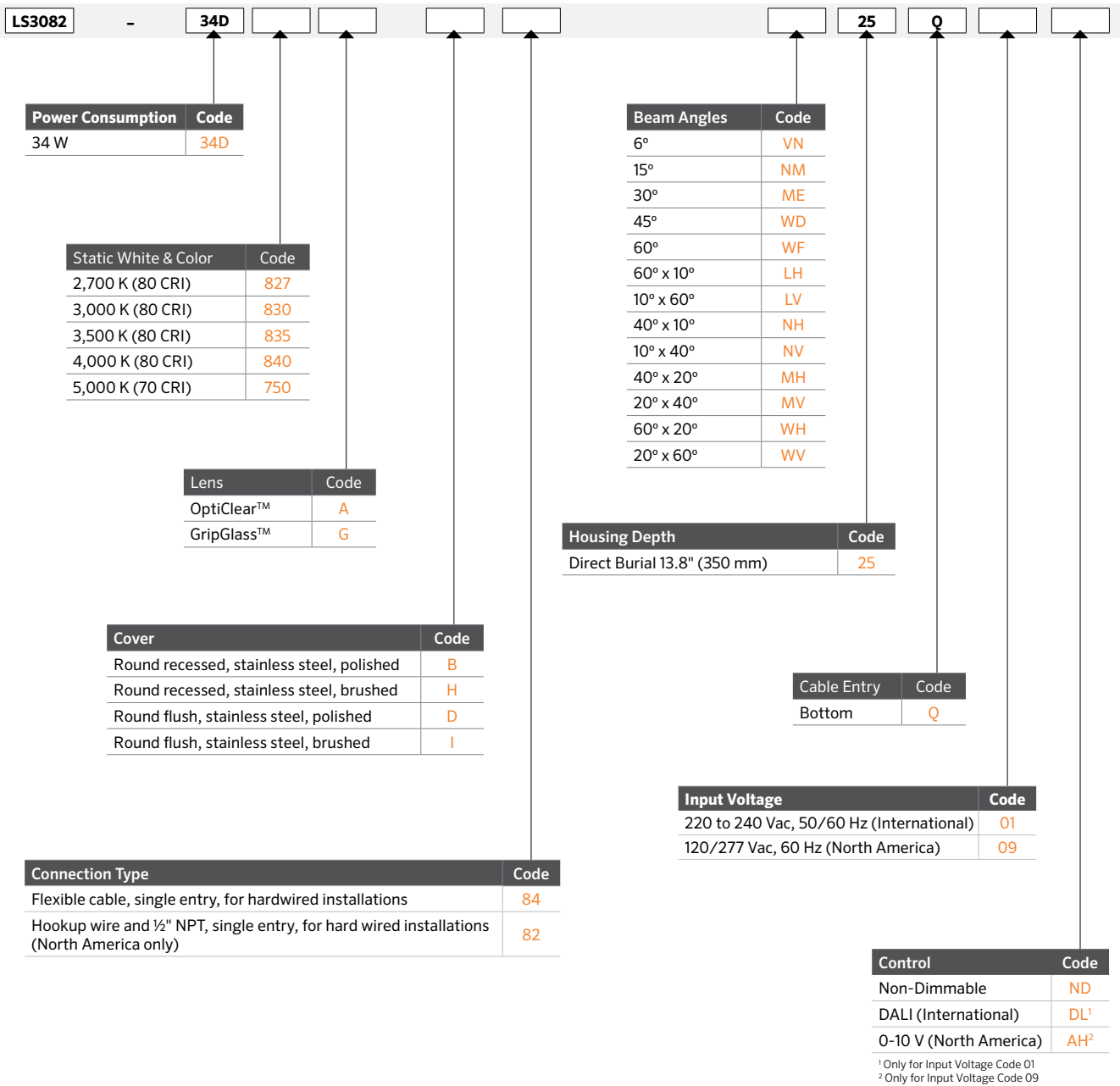

Beam Orientation for "NH" and "WH"

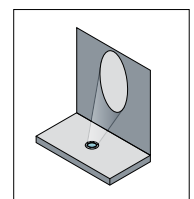

Beam Orientation for "NV" and "WV"

Network Topology - Line Voltage 220 to 240 Vac, 120/277 Vac Non-Dimmable

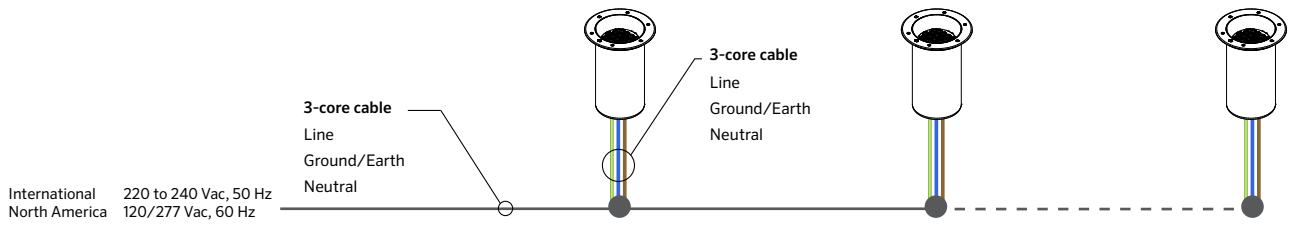

Network Topology - Line Voltage 220 to 240 Vac DALI

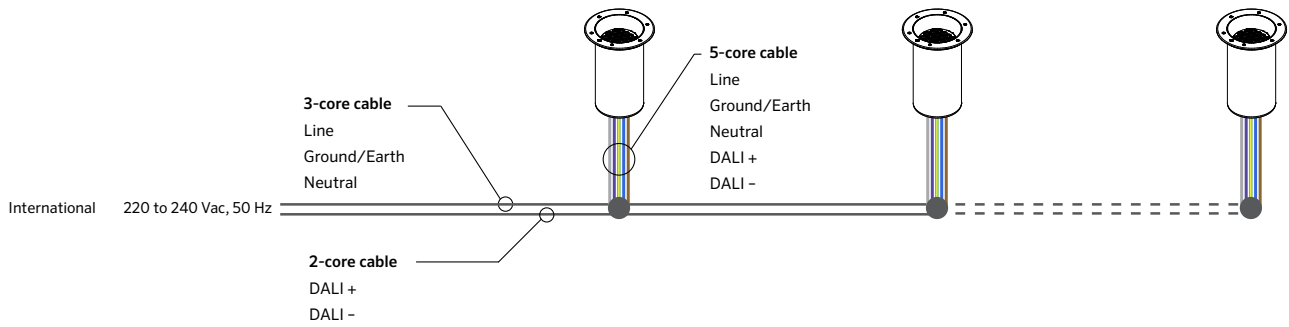

Network Topology - Line Voltage 120/277 Vac 0-10 V

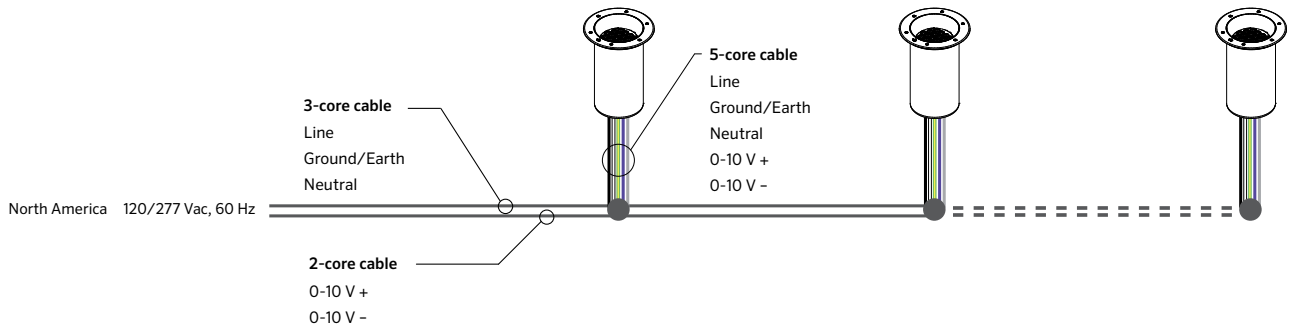

Luminaire Wire Colors & Designations

Non-Dimmable Line Voltage 220 to 240 Vac - International

Designation	Color
Line	Brown
Neutral	Blue
Ground/Earth	Green / Yellow

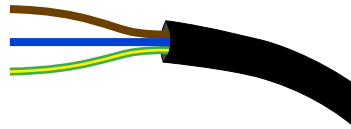

DALI Line Voltage 220 to 240 Vac - International

Designation	Color
Line	Brown
Neutral	Blue
Ground/Earth	Green / Yellow
DALI +	Grey
DALI -	Black



Non-Dimmable Line Voltage 120/277 Vac - North America

Designation	Color
Line	Black
Neutral	White
Ground/Earth	Green / Yellow

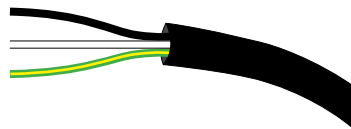

0-10 V Line Voltage 120/277 Vac - North America

Designation	Color
Line	Black
Neutral	White
Ground/Earth	Green / Yellow
0-10 V +	Purple
0-10 V -	Pink or Grey

